

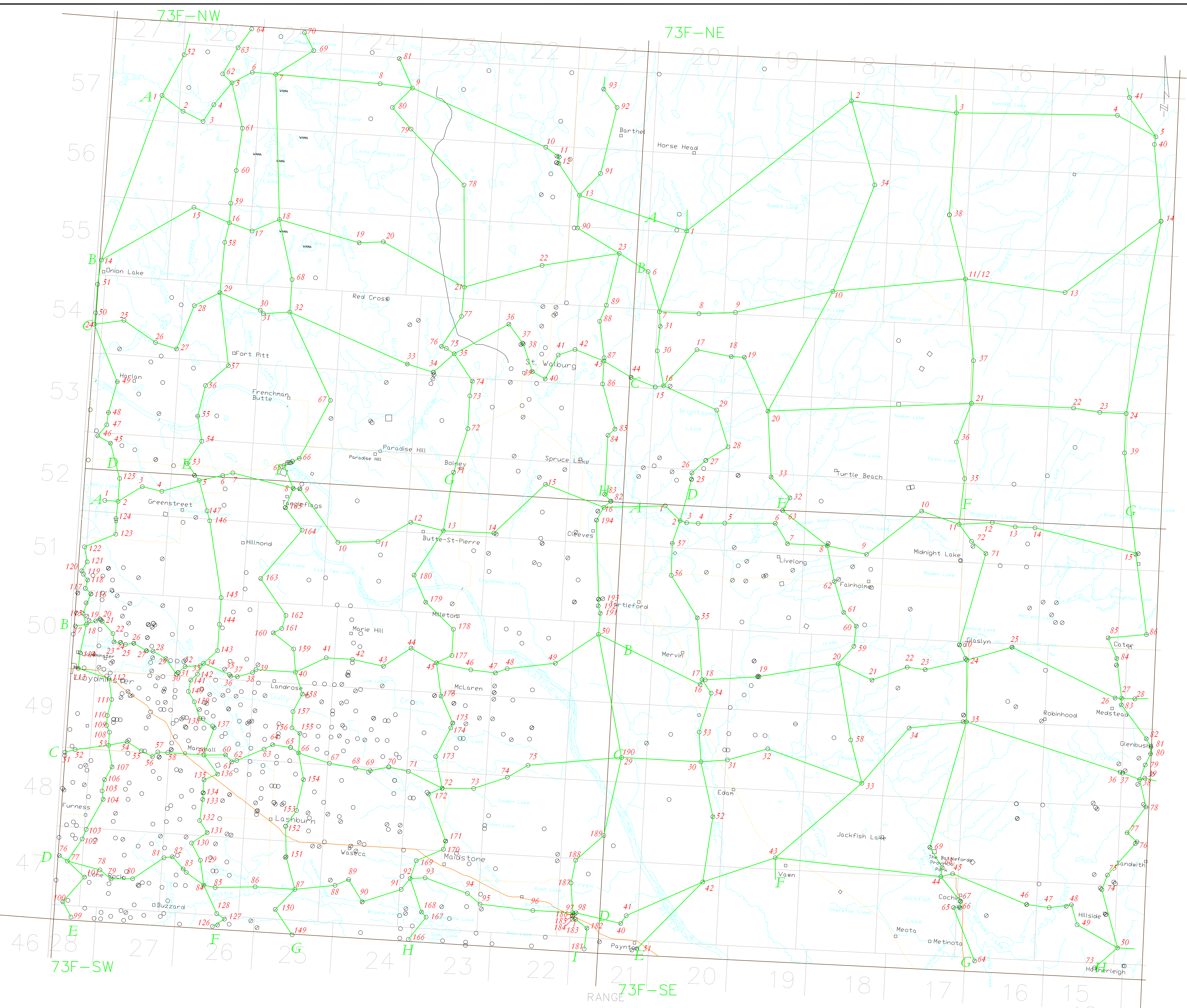

Geology and Groundwater Resources of the St. Walburg Area (73F), Saskatchewan

### Map 1a Index Map Cross sections and Testholes



#### LEGEND

- F — F' Cross Section
- <sup>137</sup> — Cross Section number
- — E-log only
- ⊖ — E-log, geologist description
- ⊙ — E-log, driller's log
- — SRC Observation Well
- ★ — Flowing well/testhole

This document may not be copied without the consent of the authors. However, copies may be made, except for resale, for personal or internal use of the client, provided the original publication is cited where applicable.

These maps are accompanied by a series of cross sections which depict the subsurface units along the transects shown on the map. The maps and cross sections are representations of the data taken from the testholes and wells indicated on the maps. The boundaries outline areas in which the aquifer or geologic unit is likely to be found. Aquifers and other geologic units may not always occur continuously within the areas shown, may not be found at a specific site or may occur at elevations other than those indicated. Discontinuous water bearing zones may be found outside the boundaries shown.

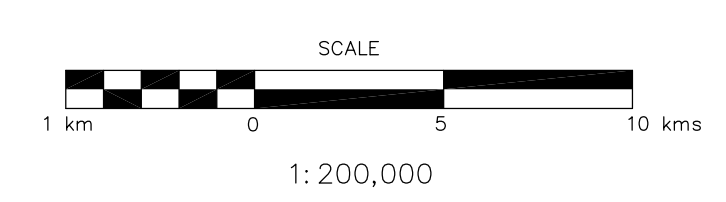

nad 83 extended zone 13  
DIGITAL BASE MAP FROM CSMA

A portion of this work was done under contract to the Saskatchewan Water Corporation. This support is gratefully acknowledged.



Points and data as of May 1988

Accompanies:  
Millard, M.J., 1990: Geology and Groundwater Resources of the St. Walburg Area (73F), Saskatchewan. Saskatchewan Research Council Report R-1210-7-E-90.

Acad drawing 73f\_ggt.dwg