

Geology and Groundwater Resources of the
Yorkton Area (62M,N),
Saskatchewan

Map 3
Sutherland Group
Sands and Gravels
(sheet 3)



Surface elev. Depth to top
Depth to water Thickness
(all units are in metres)
(depths are below ground surface)

LEGEND

F—F' Cross Section

- E-log only
- ⊖ E-log, geologist description
- ⊗ E-log, driller's log
- ⊙ No E-log, driller's log (selected testholes)
- ★ Flowing well/testhole

Accompanies:
Millard, M. J., 1992. Geology and Groundwater Resources of the Yorkton Area (62M,N), Saskatchewan. Saskatchewan Research Council Report No. R1210-1-E-92.

Asst. Director, Groundwater

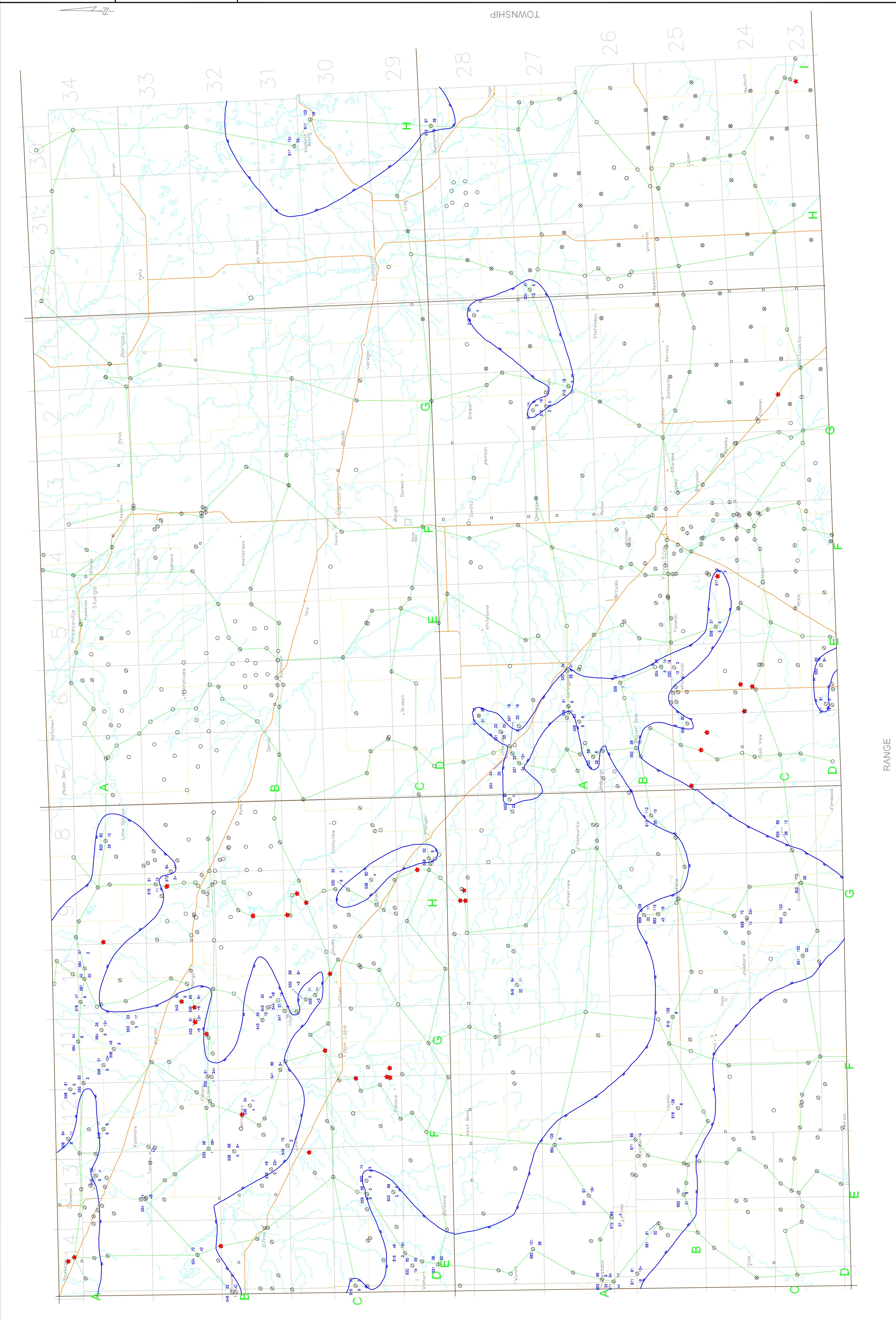

These maps are accompanied by a series of cross sections which depict the subsurface units along the transects shown on the map. The maps and cross sections are representations of the data taken from the testholes and wells indicated on the maps. The data were obtained from the testholes and wells. The maps are not a substitute for the testholes and wells. The maps are not always continuous within the areas shown. They may not be found at a specific site or may occur at elevations other than those indicated. Discontinuous water bearing zones may be found outside the boundaries shown.

This document may not be copied without the consent of the authors. However, copies may be made, except for resale, for personal or internal use of the client, provided the original publication is cited where applicable.

